



F SERIES SWIVEL JOINTS

1/4" to 2" swivels for working pressures up to 300 Bar(4350PSI).

Zinc passivated finish, Hardened carbon steel.

Style 1.

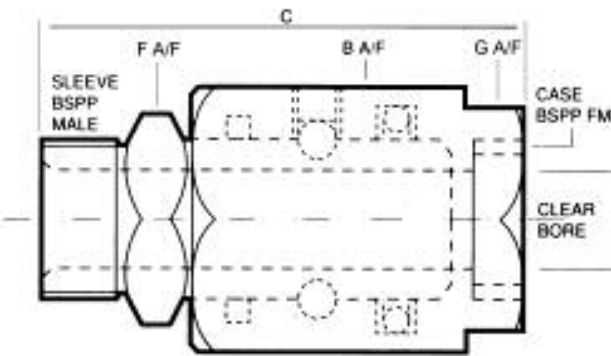

Style 2

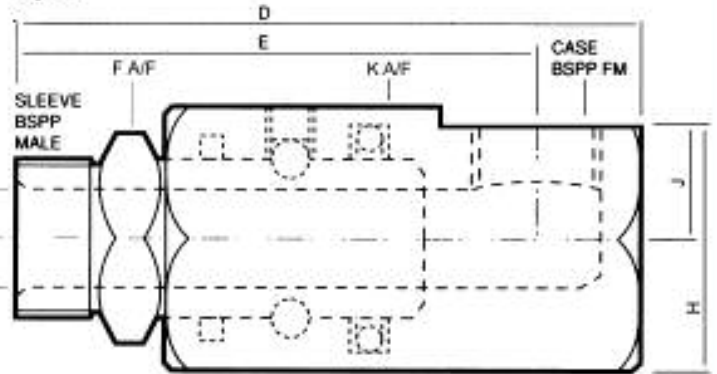

Common Dimensions					
Thread BSPP	Size Ref.	Bar	Max. RPM	Bore A Dia	F
1/4"	06	300	40	6	19
3/8"	10	250	40	8	24
1/2"	12	250	40	11	27
3/4"	20	210	25	15	34
1"	25	170	17	20	41
1 1/4"	32	130	15	28	50
1 1/2"	40	110	12	34	55
2"	50	90	8	44	70

Style 1 (Straight), mm			
B	C	G	Wt Kg
30 A/F	62	30	0.21
34 A/F	66	34	0.29
36 A/F	73	36	0.35
45 A/F	79	45	0.55
60 Dia	90	52	1.03
60 Dia	98	55	1.15
70 Dia	108	65	1.8
80 Dia	117	75	2.45

Style 2 (90 Degree), mm					
K	D	E	H	J	Wt Kg
30 A/F	72	59	28	13	0.28
34 A/F	77	60	33	16	0.40
38 A/F	87	70	34	15	0.53
50 A/F	100	80	47	22	1.04
60 Dia	112	88	52	22	1.43
64 Cast	119	87	84	52	1.9
78 Cast	138	99	102	63	3.3
84 Cast	150	108	107	65	3.4

ORDERING DETAILS. Please indicate option from each column:

E.g. F2-25-1-1 relates to F series, 90° Style, 1" Nominal Bore, Nitrile Seal, Threaded BSPP male to female.

Series	Style	Size	Seal	Temp. Guide °C	End Type
F	1	1/4"	1. Nitrile Rubber	100	1. BSPP Thread
		3/8"			
		
	2	1 1/2"	4. Viton	200	
		2"	5. PTFE	200	

Please Enquire About Specials:

Alternative materials - 316SS
 Custom built applications:
 High Pressure, Hygienic duty,
 Multiflow, Low Torque.
 Large Bore applications to 30" NB.



ROTAFLW FV LIMITED

Tech spec:
107/040322

Rotec House, Bingswood Trading Estate, Whaley Bridge,
 High Peak, SK23 7LY. Tel: 01663 735003 Fax: 01663 735006
 E-mail: sales@rotaflow.com Web: www.rotaflow.com