

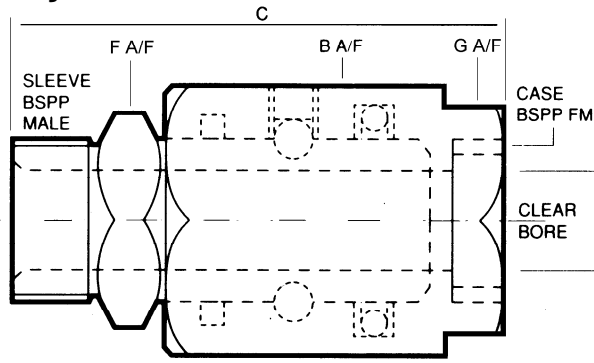

# F SERIES SWIVEL JOINTS

1/4" to 2" Carbon Steel Swivels to 300Bar (4,350PSI)

Style 1



Style 2

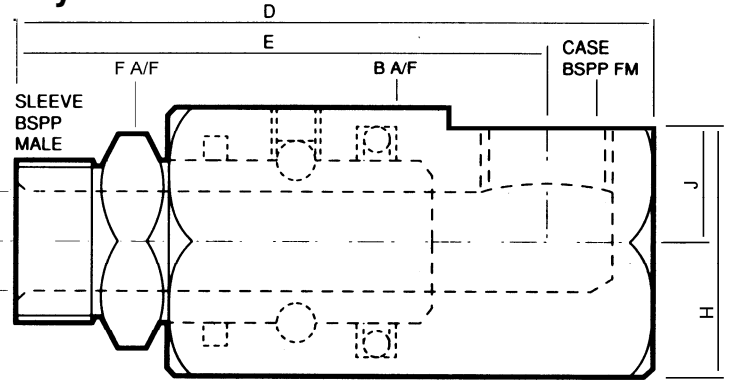

Common Dimensions					Style 1 (Straight) mm					Style 2 (90 Degree) mm					
Thread BSPP	Size ref	Bar	Max. RPM	Bore A Dia.	F	B	C	G	Wt (Kg)	K	D	E	H	J	Wt (Kg)
1/4"	6	300	40	6	19	30 A/F	62	30	0.21	30 A/F	72	59	28	13	0.28
3/8"	10	250	40	8	24	34 A/F	66	34	0.29	34 A/F	77	60	33	16	0.4
1/2"	12	250	40	11	27	36 A/F	73	36	0.35	38 A/F	87	70	34	15	0.53
3/4"	20	210	25	15	34	45 A/F	79	45	0.55	50 A/F	100	80	47	22	1.04
1"	25	170	17	20	41	60 Dia	90	52	1.03	60 Dia	112	88	52	22	1.43
1 1/4"	32	130	15	28	50	60 Dia	98	55	1.15	64 Cast	119	87	84	52	1.9
1 1/2"	40	110	12	34	55	70 Dia	108	65	1.8	78 Cast	138	99	102	63	3.3
2"	50	90	8	44	70	80 Dia	117	75	2.45	84 Cast	150	108	107	65	3.4

**ORDERING DETAILS:** Please indicate one option from each column.

E.g. F2-25-1-1 relates to F series, 90° style 1" nominal bore, PTFE seal, Threaded BSPP male to female.

SERIES	STYLE	SIZE (mm)	Thread size	SEAL	END TYPE
F	1. (STRAIGHT)	06	1/4"	1. NITRILE	1. BSPP THREAD
	2. (90 DEGREE)	10	3/8"	3. EPR	
		12	1/2"	4. FLUOROCARBON (VITON®)	
		20	3/4"	5. PTFE	
		25	1"		
		32	1 1/4"		
		40	1 1/2"		
		50	2"		

Viton® is a registered trademark of DuPont Dow Elastomers.



Please Enquire About Specials:

Alternative materials—316SS  
 Custom built applications:  
 High Pressure, Hygienic duty,  
 Multiflow, Low torque.  
 Large Bore applications to 30" NB

For larger sizes please view our SK series brochures.

Also available in Stainless Steel from our 'FS' series Catalogue - (1/4" to 2")

Copyright © 2011 Rotaflow FV LTD

## ROTAFLOW FV LIMITED

Rotec House, Bingswood Trading Estate,  
 Whaley Bridge, High Peak, SK23 7LY.  
 Tel: 01663 735003 Fax: 01663 735006  
 E-mail: sales@rotaflow.com

Tech Spec:  
 107/100416  
 Page 1 of 1

Web: [www.rotaflow.com](http://www.rotaflow.com)