

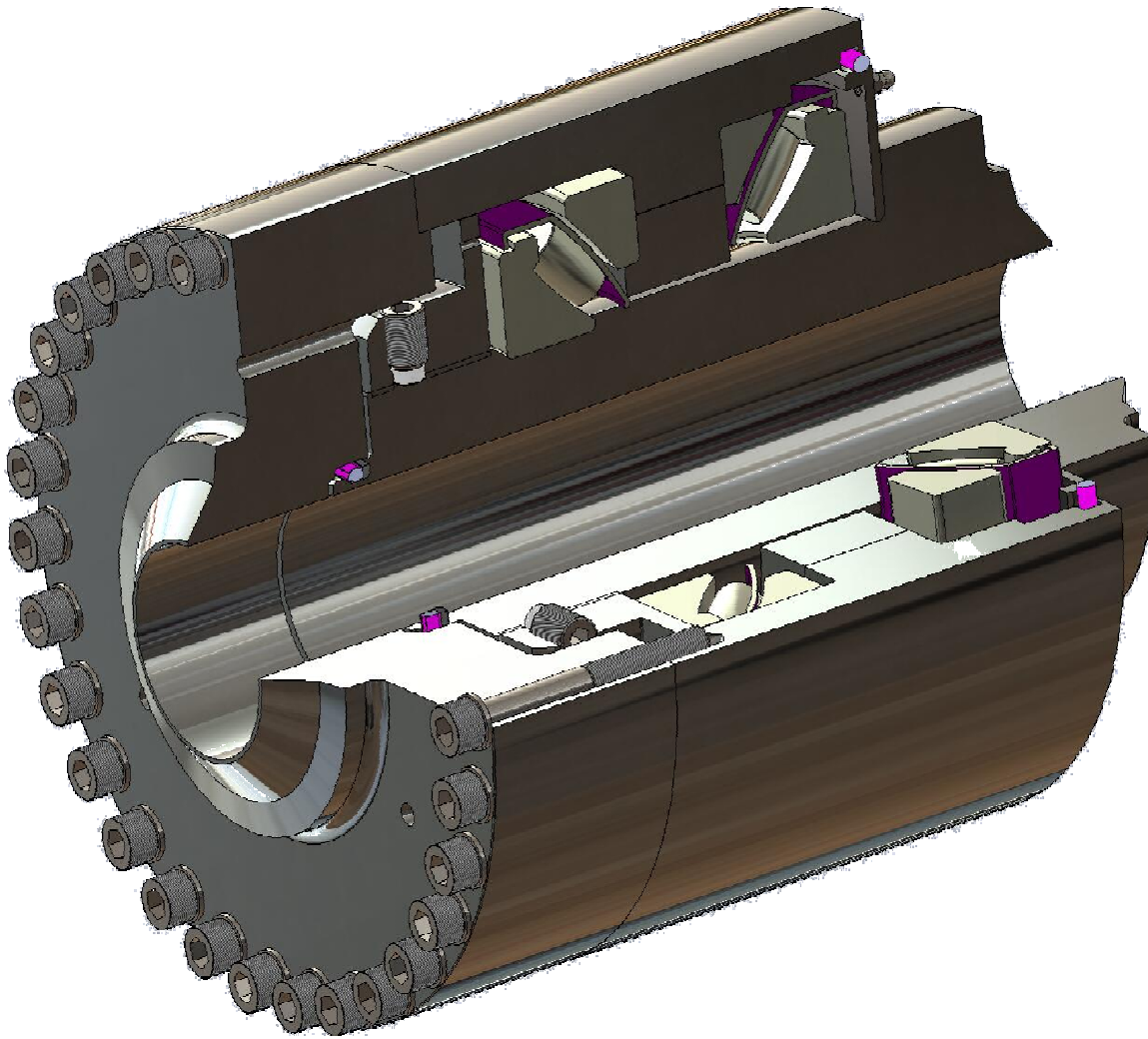

# HIGH PRESSURE SWIVEL JOINTS

## NOMINAL BORE 1" TO 24"



### High Pressure Design Swivel Joint

- ❑ Proven in the field at **15,000 PSI** (1034 Bar). Factory tested designs up to 27,000 PSI for intermittent and continuous rotation.
- ❑ Testing to **40,500 PSI** (2800 Bar) Static.
- ❑ PTFE Seals for a wide range of medium compatibility and good temperature operating range (-70°C to 200°C) with minimal torque drag (resistance to rotation between the fixed and rotating elements).
- ❑ Tough tapered or spherical roller bearings to take high radial, axial and bending loads. And to keep torque to turn to a minimum.
- ❑ Leak detection ports incorporated for early detection of any seal leakage.
- ❑ Available in Carbon Steel, Stainless Steel, other metals on application.
- ❑ Bespoke manufactured to customers specific duty requirements.
- ❑ Manufactured to customers end condition i.e Elbows, Flanges fully welded. (Coded welding and testing to full P.E.D requirements if required).

Please contact Rotaflow and discuss your application.

## ROTAFLOW FV LIMITED

Rotec House, Bingswood Trading Estate,  
Whaley Bridge, High Peak, SK23 7LY.  
Tel: 01663 735003 Fax: 01663 735006  
E-mail: sales@rotaflow.com

Tech Spec:  
153/110516  
Page 1 of 1

Web: [www.rotaflow.com](http://www.rotaflow.com)